

ORWAK POWER

3325
3420
3820

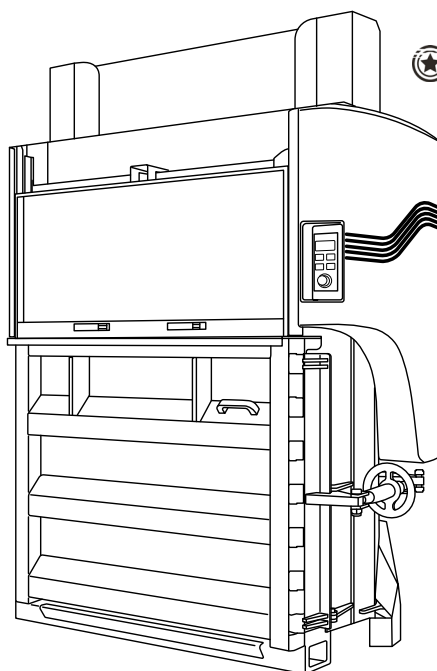

 BLACK STAR TECHNOLOGY

ORIGINAL OPERATING INSTRUCTIONS





CONTENTS

Safety information.....	4
Parts of the machine.....	5
Safety.....	6
THE ORWAK POWER FAMILY.....	8
Control panel.....	9
Operating instruction.....	10
Weekly inspection and maintenance.....	12
CE.....	13
Technical specification....	14
Dimensional drawing.....	15
Transport.....	15
Installation.....	16

Electrical diagram

Hydraulic diagram

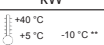
IDENTIFICATION

 Svetsaregatan 4 576 33 Sävsjö Sweden		
Type *	Date	
Product No * * *	Weight	
Serial No * *		
V ~ Hz		
kW	A	
		
		
		

- * - XXXX (ex Compactor 3420)
- ** - XXXXXX (ex 151001)
- *** - 490XXXX - XX (ex 4903420-00)

You find the serial number on the baler.

For any inquiries, please indicate the type and serial number of the baler.

OPERATOR WARNING & DUTY

This manual must be available permanently near the baler. Each operator must read and follow the full instruction of this manual before being authorize.

All operator must absolutely study and fully understand the operator's manual, specifically pay a particular attention to the safety procedure section.

In case of misunderstanding or doubt, do not start the machine. Contact support service.

Operators and service staff must comply by wearing personal protective equipment (PPE) before using or performing any maintenance operation following rule and regulation code.



Operator and service personal must be trained during the commissioning on the baler operation, by a duly authorized person from the manufacturer.

To avoid any mistake or accident, all operators must understand the operator manual.



All operators must absolutely study and fully understand the operator's manual.
This manual must remain available for any personal involve with the baler.

SAFETY SIGN - In the manual



Warning !



The main power switch must be turned off to « 0 » and secured with a padlock.



Do not flush water on the baler.

SAFETY SIGN - On the baler



Danger High Voltage

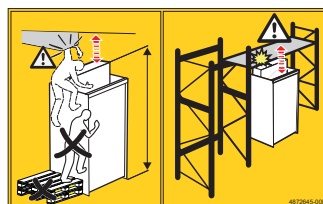

Never climb on the machine!
It is forbidden to go on top of the machine. Note also that the sliding door moves upwards when the power supply is interrupted or an emergency stop is activated. Risk of crushing on top of the machine.



The main power switch must be turned off to « 0 » and secured with a padlock before service or cleaning.

Position yourself to the **SIDE OF** the machine, outside the risk area.
Ensure that no one is in the risk area!

PARTS OF THE MACHINE

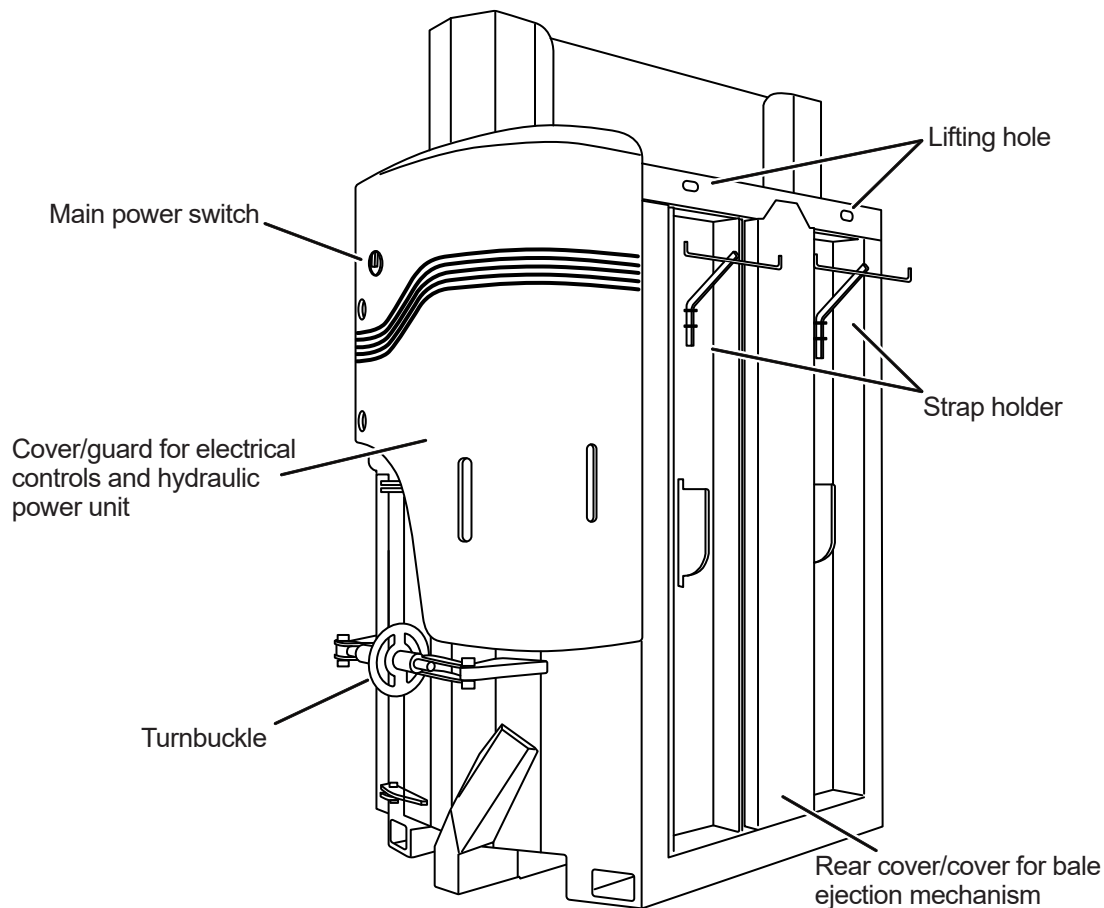
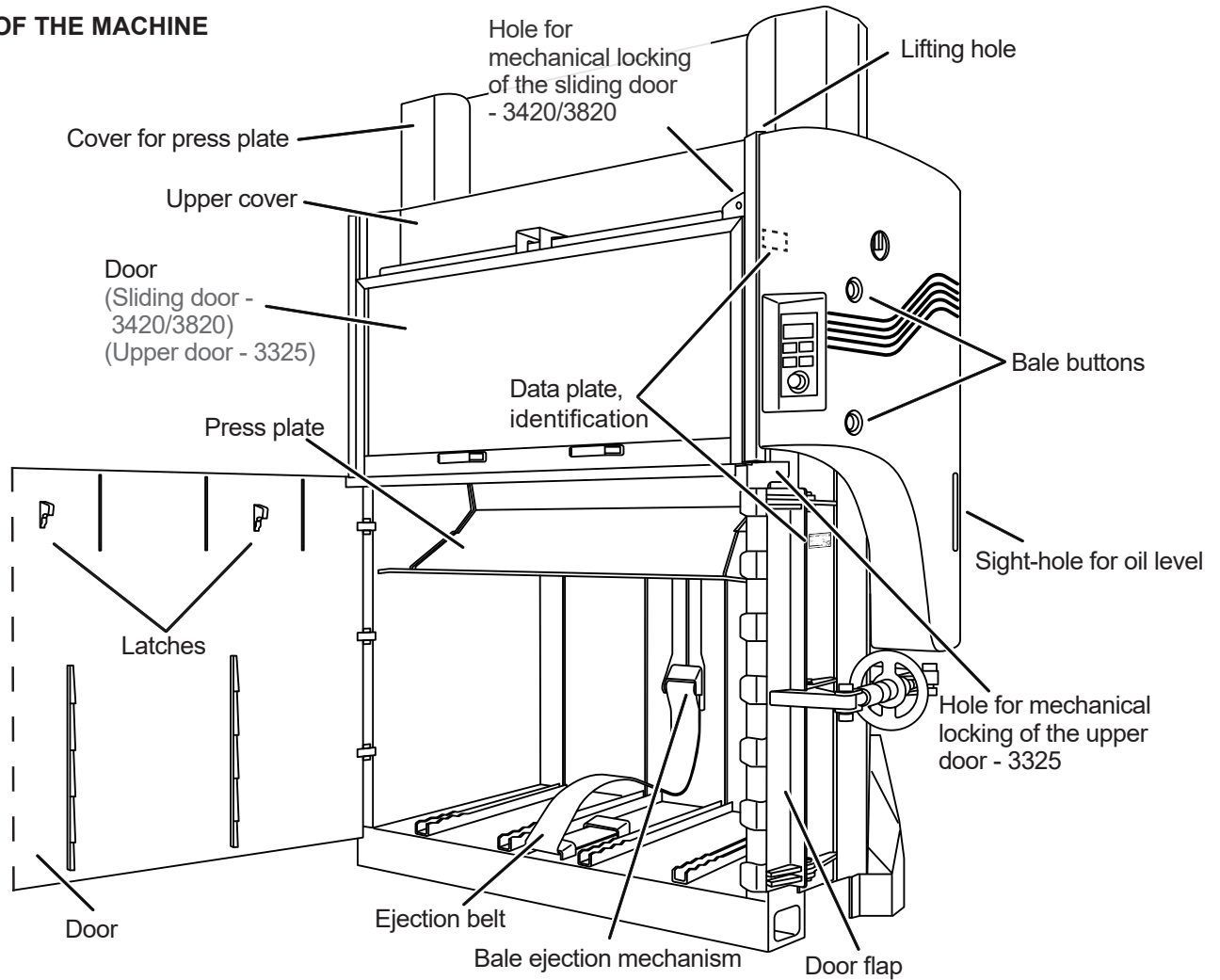

SAFETY

Please read the whole of the operating instructions **BEFORE** installing and starting the machine. Our **Warranty and Product Responsibility** require that:

- instructions are followed, and that no alterations or modifications are carried out.
- original spare parts, and hydraulic oils and lubricants recommended by the machine manufacturer are used.
- at least one annual service is carried out.

The user of the machine is responsible for the safety checks, and for ensuring that daily maintenance of the machine is carried out.

The user is responsible for ensuring that defects are rectified, and that neither the user or other persons are exposed to danger.

The owner is responsible for ensuring that national and local laws are complied with when using the machine.



This symbol means **WARNING or DANGER** – personal safety instruction!



This machine is designed for **ONE-MAN OPERATION**.

Only the operator is allowed in the working area of the machine.



The machine must not be used if the safety features (e.g. switches and covers) **have been rendered inoperative, damaged or removed**.

Lost or damaged parts must be replaced with original spare parts.



The area immediately around the machine and its base must be completely level and suitable for the weight of the machine.

The machine has a **high centre of gravity**. Before moving the machine, the press plate should be fully lowered and the sliding door/upper door locked mechanically.



When installing: Note that the installed height of the machine is higher than its transport height. Installation must only be carried out by trained personnel, and in accordance with the installation instructions.



Never climb on the machine! It is forbidden to go on top of the machine.

Note also that the sliding door moves upwards when the power supply is interrupted or an emergency stop is activated. Risk of crushing on top of the machine.



The machine may only be operated by a person who has received **training and has experience** of the machine.



Servicing and repairs must only be carried out by trained personnel, and in accordance with the servicing instructions.



Only authorised personnel may remove covers and guards, and then only by first turning the main power switch to the off position. *The power supply side of the main power switch is always live!*



The machine contains current-carrying components and must not therefore be placed in an environment where it can be exposed to moisture.



The machine must not be used by minors.



The machine must not be used in a public environment. It is intended for use in warehouses or other similar places.



Use the handle on the door when the door is to be closed. Warning: risk of crushing.



An adapted cable must be used if the input cable is replaced. See the spare parts catalogue. The cable must not be spliced.



The machine must be placed on a stable and level surface having the capacity to support the machine at all times. **NOTE!** If the surface not is in level, anchor the machine to the ground!

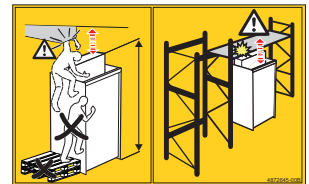

SAFETY FEATURES

The machine is equipped with the following **safety features**:

A sliding door/upper door switch that prevents compacting with the sliding door/upper door open.

A door switch that prevents compacting with the door open.

Covers and guards conceal the hydraulics and moving parts of the machine. **NOTE!** Not on top of the machine however. Exercise care! Risk of crushing!

The door pressure is relieved when the door is opened.

Baling is performed from the side of the machine so that the operator is kept away from the baling area.

The machine is equipped with an **emergency stop**.

The machine is equipped with a **lockable main power switch** (to prevent unauthorised use, e.g. during servicing and maintenance, or when removing any waste that has become trapped).

The sliding door is fitted with **gas springs** to damp its movement as it is closed.

RANGE OF APPLICATION

The machine is a hydraulically operated baler intended for compacting non-rigid materials such as corrugated cardboard, paper and plastic. The material being compacted should be evenly distributed in the chamber. Compaction of compact or pre-compressed material may result in damage to the machine. The machine must only be used in areas that are provided with a roof, normal lighting and protection against wind. The machine is intended for use in the temperature range from -10°C to +40°C. A low-temperature oil and/or a heater (option) should be used at temperatures below +5°C. To ensure the maximum possible personal safety, the machine must be installed with a residual current device (RCD).

The control panel includes a selector marked PAPER/PLASTIC. This indicates high pressure (PAPER) and low pressure (PLASTIC). Low pressure is used for plastic, and high pressure for corrugated cardboard. Using high pressure (PAPER) for plastic may cause damage to the machine.



The machine is equipped with a button for selecting manual (MAN) or automatic (AUTO) starting of the press cycle. When the machine is set to AUTO, the press cycle will start automatically once the sliding door/upper door is closed. The machine comes preset to manual (MAN) from the factory.

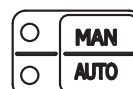

These operating instructions describe both operating procedures under the heading OPERATING INSTRUCTIONS. If it is wished to remove a smaller bale in automatic mode (AUTO), i.e. before the bale light flashes,

the selector must be set to manual mode (MAN) – see the operating instructions for manual baling.

The operating procedures described under OPERATING INSTRUCTIONS include illustrations of a machine with a sliding door (model 3420/3820). The sliding door is pushed up or pulled down for opening and closing respectively. The model 3325 are provided with a hinged upper door.

If it is wished to close the sliding door/upper door without the machine starting automatically, the selector must be set to manual mode (MAN) before closing the sliding door/upper door.

The sliding door is kept closed with an electromagnet. This operates only when the machine is carrying a current. The sliding door can, of course, be locked in the closed position with the help of a padlock (e.g. during transport), see the section PARTS OF THE MACHINE.

SERVICE LIFE OF SAFETY-RELATED PARTS OF THE CONTROL SYSTEM (srp/cs)

Safety-related parts of the control system have a maximum service life of 20 years. This service life is determined from the outset by the standard for machine control systems, EN ISO 13849-1. This machine is designed to ensure a safe function for those who will operate the machine according to the relevant standard EN ISO 13849-1. Check the data plate on the machine to find out when the machine was manufactured. Contact an authorised service point to obtain help with questions relating to servicing and the replacement of components.



Materials that are flammable or of an explosive nature, such as pressurised containers or the like, which, when exposed to pressure or sparks, could cause damage, fire or an explosion, must not be compacted in the machine.



Only use straps or wire (steel wire ≥ 3 mm) recommended by the machine manufacturer.



Warning! If steel wire is used to bind the bale, safety glasses and protective gloves should be worn.



Heavily expanding materials, for example bubble plastic, must not be compacted in the machine.



ENVIRONMENT AND FIRE

In the event of a fire: put out the burning oil with a carbon dioxide or powder extinguisher. Any fire in the electrical system should be put out with a carbon dioxide extinguisher.

If possible, a binding agent for oil should be stored in the immediate vicinity of the machine, and the machine should not be installed directly over or close to drains.

3325
Hinged upper door,
press force 260 kN.

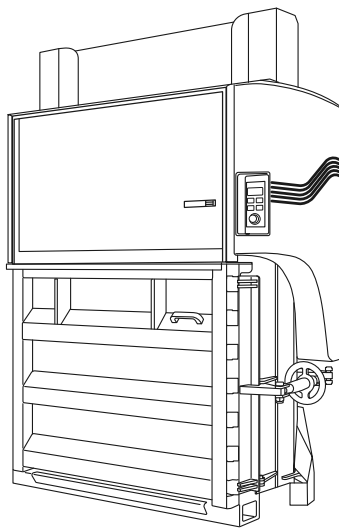

3420
Sliding upper door,
press force 260 kN,
narrower than the 3820.

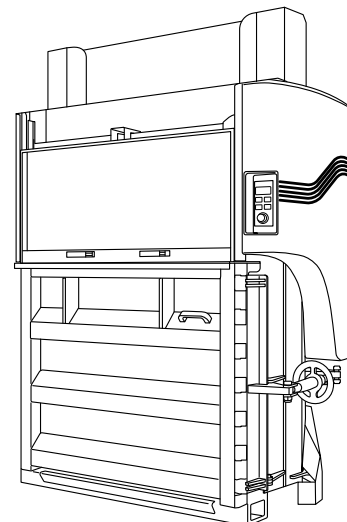

3820
Sliding upper door,
press force 260 kN,
wider than the 3420.

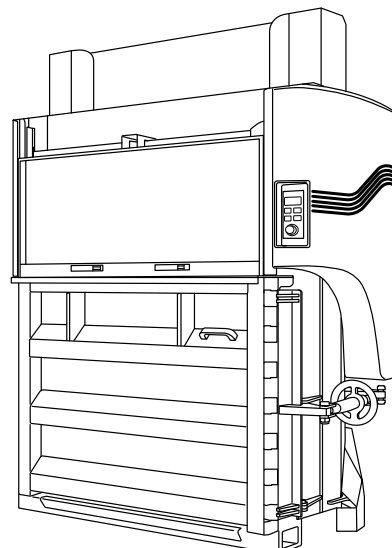

CONTROL PANEL

Bale light – the light indicates when it is time to remove the bale from the machine.

Paper – indicates that the machine is set to compact paper and cardboard. The machine exerts a higher pressure.

Plastic – indicates that the machine is set to compact plastic. The machine exerts a lower pressure. See **Technical specifications** for more details.

If the machine is set to *plastic* and *MAN* mode when a press cycle is run, the press plate will remain pressed down against the waste for 2.5 minutes (default), after which it will press one more time (default) and remain pressed down for a further 2.5 minutes before moving up again. The *up arrow* will remain lit during this time. To cancel: press the *up arrow*.

If the machine is set to *plastic* and *AUTO* mode when a press cycle is run, the machine will perform a normal press cycle (exerting low pressure).

MAN – indicates that the machine is set to manual start. The start button must be pressed in to start a press cycle.

AUTO – indicates that the machine is set to automatic start. This means that the machine will start a press cycle when the sliding door/upper door is closed.

Start – starts a press cycle (for manual start).

Temperature warning lights

Blue light indicates that the machine is cold. The machine can still be operated.

Red light indicates that the machine has overheated and CANNOT be operated until it has returned to its normal temperature and the lamp has gone out.

Service light – see under TROUBLESHOOTING below for more information.

Power light – this light indicates that there is power to the machine.

Bale size – indicates the selected bale size on five levels. The bale size can be fixed. Contact your local distributor for more information.

Up arrow – used to raise the press plate to its normal position.

Down arrow – used for lowering the press plate. The press plate will come to a stop WITH PRESSURE against the bale in the lower position (e.g. for manual baling).

Emergency stop – used if a press cycle has to be stopped immediately.

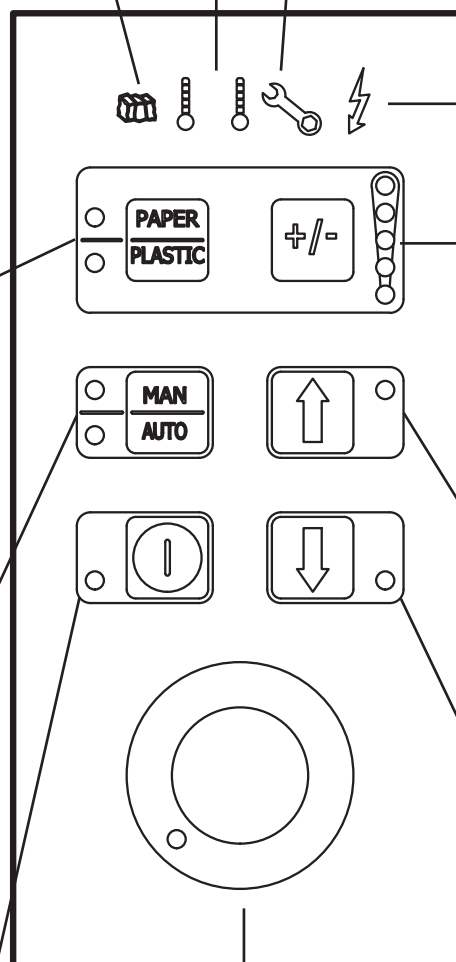

TROUBLESHOOTING

Flashing service light = fault.

Fault messages can be read via the service light.

First try turning on and off with the main power switch and try to restart the machine.

If the fault persists and the service key flashing again don't turn off the power: instead press the emergency stop button, after some seconds there will be a number of flash-es, e.g. LED extinguished for 5, 10 or 15 seconds followed by 1 to 9 flashes. (Example 5 second 3 flash or 10 seconds 2 flash.)

For optimal service help – mention the flashing message when reporting the fault.

Do not use the machine until an authorised service engineer has corrected the fault.

Service light, steady light = time for servicing. Contact your authorised service engineer.

The machine can continue to be operated.

English

OPERATING INSTRUCTIONS, operating procedure – manual start

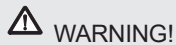

WARNING!
Only the operator is
allowed in the working
area of the machine!

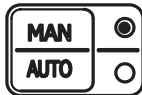

Mounting the straps

Open the lower door by first opening the flap with the turnbuckle.

- 1 Place the strap rolls in the strap holders on the rear of the machine.
- 2 Pull the bale straps **over** the pin and into the chamber.
- 3 Fasten the bale straps with a loop at the bottom of the chamber (in the groove in the beam).
- 4 Place the bale straps in the strap slots using the strap hook.
- 5 Use the door handle to close the door. Fasten the flap shut with the turnbuckle.
- 6 Reset by closing the sliding door/upper door and pressing the start button (green). The machine performs an empty cycle and is then ready for operation.

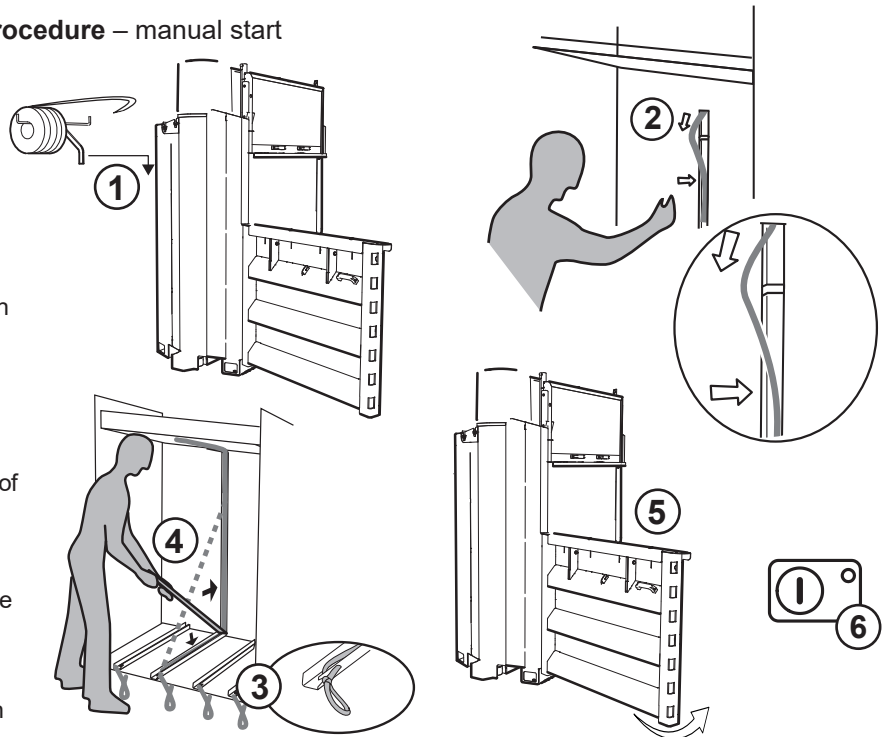

Compaction

- 7 Open the sliding door/upper door.
For a better baling result, place a large piece of cardboard/flattened cardboard box in the bottom of the chamber.
- 8 Place the waste in the chamber such that it is evenly distributed.
- 9 Close the door.
- 10 Press the start button (green).
The machine performs a press cycle.

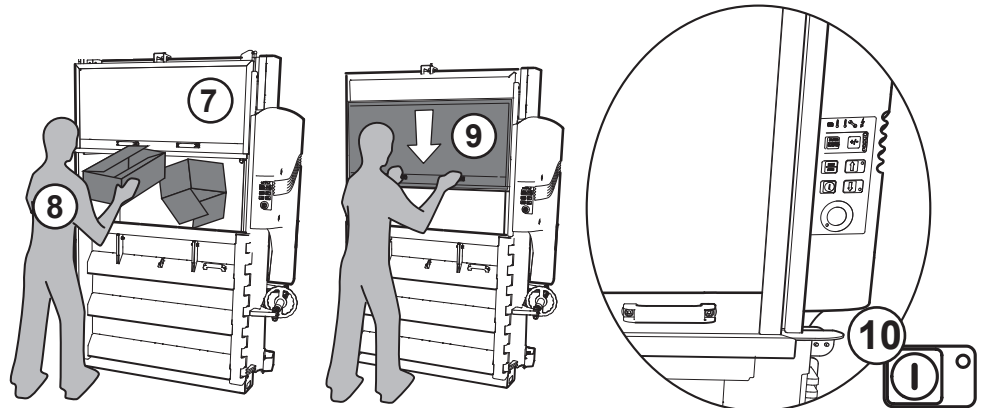

Baling (full bale)

- 11 The bale light flashes yellow when the bale is ready – it is time to remove the bale.
- 12 For a better baling result, place a large piece of cardboard/flattened cardboard box on top of the bale. Then pull the straps forward over the bale.
- 13 Use the strap knife to cut the straps.
- 14 The down arrow flashes - press the down-arrow button to acknowledge that the straps are mounted.
- 15 Close the door.
- 16 Press the down arrow.
- 17 The press plate lowers and stops down against the waste.
Make sure that no one is in the risk area. Open the door fully.
- 18 Tie the straps.
Place a pallet in front of the machine.
Make sure that no one is in the risk area (in front of the machine).
- 19 Position yourself to the **SIDE OF** the machine, outside the area of risk. Simultaneously press the bale buttons. The press plate will rise and the bale will fall out.
Repeat from Point 2.

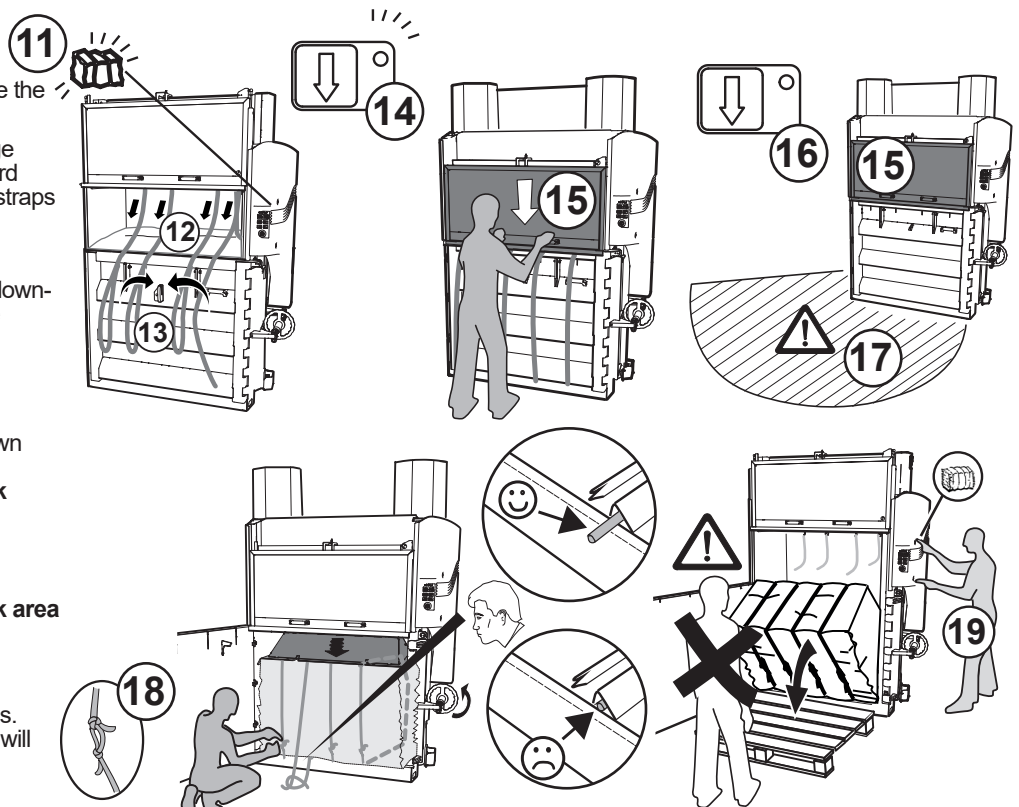

OPERATING INSTRUCTIONS, operating procedure – automatic start

Mounting the straps

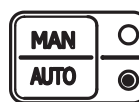
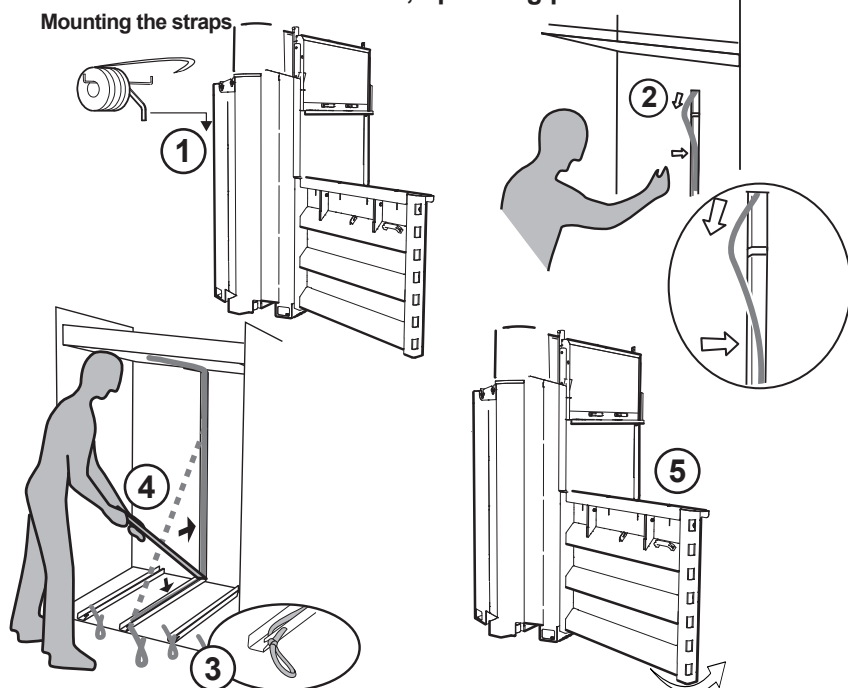

WARNING!
Only the operator is allowed in the working area of the machine!

Mounting the straps

Open the lower door by first opening the flap with the turnbuckle.

- 1 Place the strap rolls in the strap holders on the rear of the machine.
- 2 Pull the bale straps over the pin and into the chamber.
- 3 Fasten the bale straps with a loop at the bottom of the chamber (in the groove in the beam).
- 4 Place the bale straps in the strap slots using the strap hook.
- 5 Use the door handle to close the door. Fasten the flap shut with the turnbuckle.

Reset by closing the sliding door/upper door. The machine performs an empty cycle and is then ready for operation.

Compaction

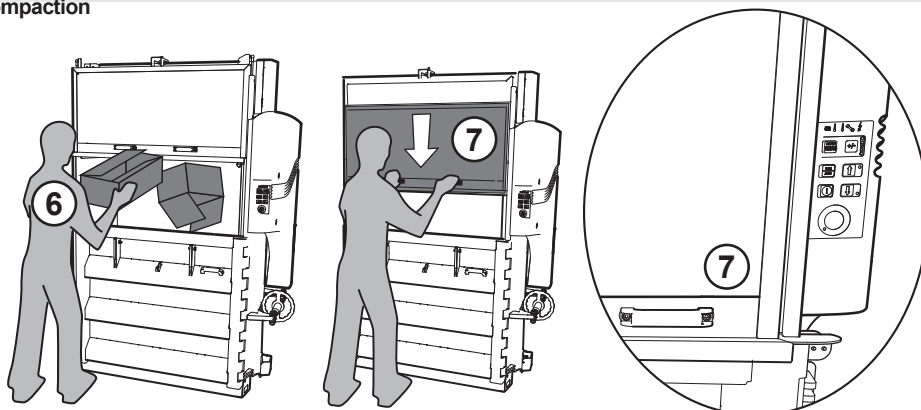

Compaction

For a better baling result, place a large piece of cardboard/ flattened cardboard box in the bottom of the chamber.

- 6 Place the waste in the chamber such that it is evenly distributed.
- 7 Close the door.
The machine performs a press cycle.

Baling (full bale)

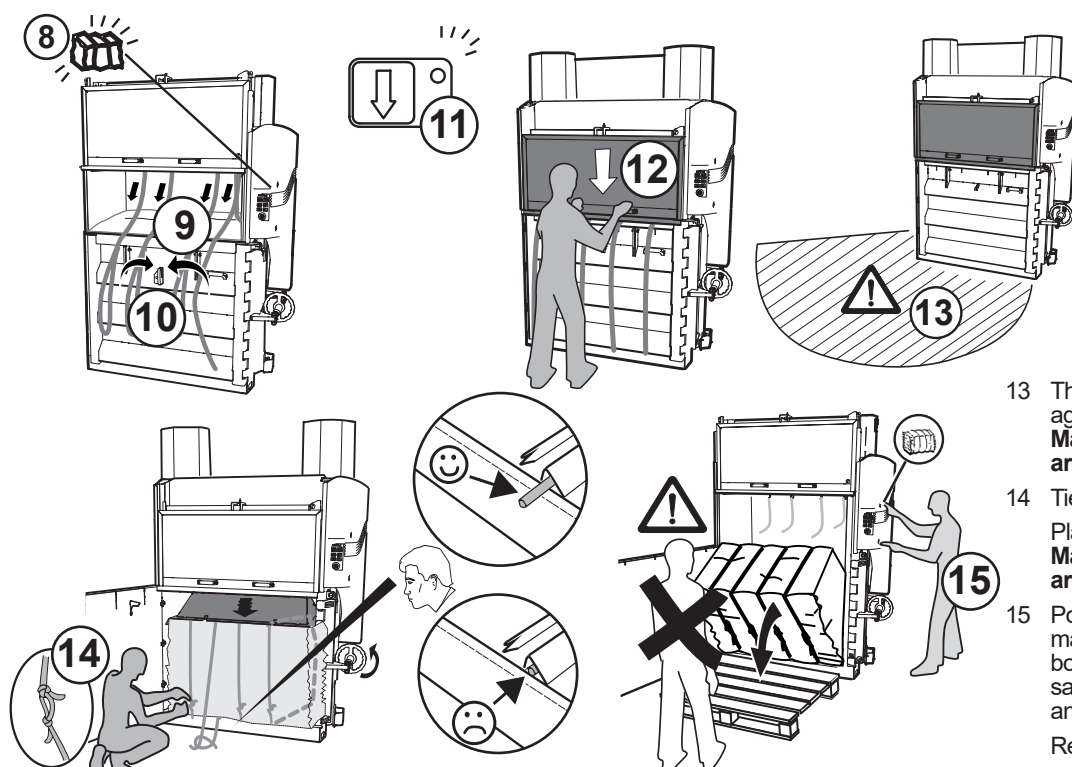

Baling (full bale)

- 8 The bale light flashes yellow when the bale is ready – it is time to remove the bale.
- 9 For a better baling result, place a large piece of cardboard/ flattened cardboard box on top of the bale.
Then pull the straps forward over the bale.
- 10 Use the strap knife to cut the straps.
- 11 The down arrow flashes - press the down-arrow button to acknowledge that the straps are mounted.
- 12 Close the door.
- 13 The press plate lowers and stops down against the waste.
Make sure that no one is in the risk area. Open the door fully.
- 14 Tie the straps.
Place a pallet in front of the machine.
Make sure that no one is in the risk area (in front of the machine).
- 15 Position yourself to the SIDE OF the machine, outside the area of risk. Hold both of the bale removal devices at the same time. The press plate will rise and the bale will fall out.
Repeat from Point 2.

English

WEEKLY INSPECTION AND MAINTENANCE

NOTE! During inspection and maintenance, servicing and the removal of trapped waste, etc:

1. Always turn the main power switch to "0" and secure it with a padlock.
2. Do not work inside the machine.

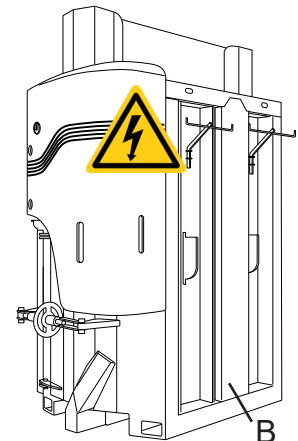
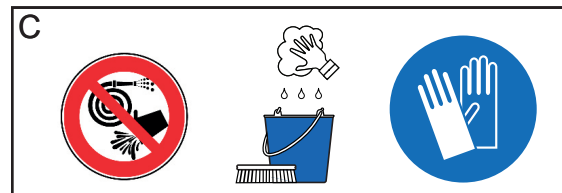
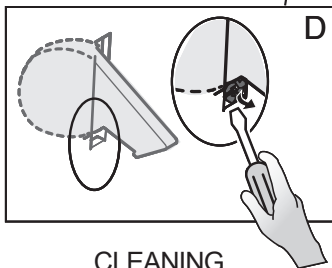
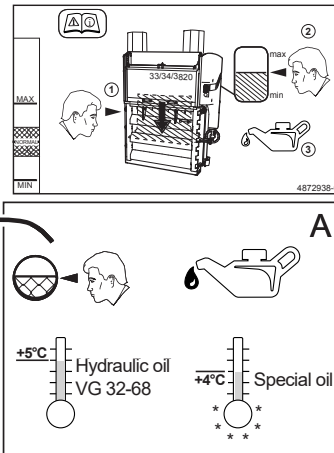
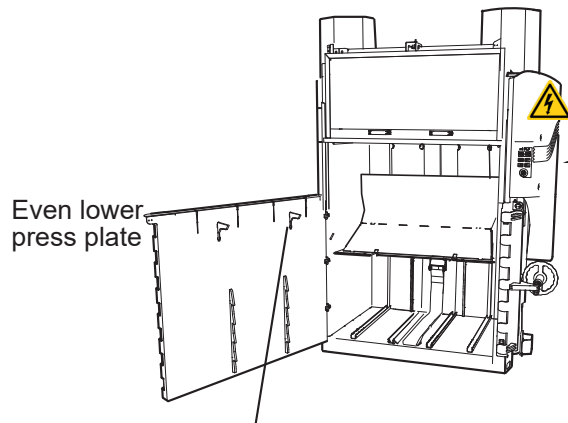
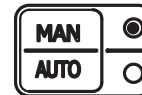

CLEANING

Clean around the latches (D) and behind the cover for the bale ejection mechanism (B). Remove any waste. Clean the press plate. Make sure that there are no bales in the machine. First lower the press plate using the down-arrow button. Open the door. Remove any waste. Use the strap hook to gain access to the rear of the press plate. NOTE: The main power switch should be in position 0. Use a slightly moistened rag to clean the chamber and the outside of the machine (C). Never wash the machine.

SAFETY CHECKS

- Check the sliding door/upper door switch and the lower door switch: it must not be possible to start the machine if the sliding door/upper door or the lower door is open/opened.
- Check the bale buttons: it must not be possible to remove the bale from the machine using only one button.
- Check that the emergency stop is working.
- The gas springs are important for damping the sliding door. Their function should therefore be checked regularly.
- Check that there are no oil leaks on the machine.
- Check that no parts are loose or damaged and that all covers are fitted.
- Check that the power cable is intact and properly protected against impact.

If any fault is found in the functions above, the machine must not be used until it has been repaired by authorised service personnel.

Service and repairs must only be carried out by competent personnel, and in accordance with the machine manufacturer's instructions.

TROUBLESHOOTING

Flashing service light = fault.

Fault messages can be read via the service light.

First try turning on and off with the main power switch and try to restart the machine.

If the fault persists and the service key flashing again don't turn off the power: instead press the emergency stop button, after some seconds there will be a number of flashes, e.g. LED extinguished for 5, 10 or 15 seconds followed by 1 to 9 flashes. (Example 5 second 3 flash or 10 seconds 2 flash.)

For optimal service help – mention the flashing message when reporting the fault.

Do not use the machine until an authorised service engineer has corrected the fault.

Service light, steady light = time for servicing. Contact your authorised service engineer.

The machine can continue to be operated.

When changing the oil: Contact the local authorities for guidance regarding the environmentally correct disposal of waste oil. Miscibility must be taken into account when changing and/or topping up the oil. The machine comes filled with mineral oil from the factory.



EC DECLARATION OF CONFORMITY



Orwak AB
Svetsaregatan 4
SE-576 33 Sävsjö
Sweden
Tel. : 46-382-15700

declare under our sole responsibility that the product models

4903325-00 – 4903325-99; 4903325-S001 – 4903325-S999

4903420-00 – 4903420-99; 4903420-S001 – 4903420-S999

4903820-00 – 4903820-99; 4903820-S001 – 4903820-S999

to which this declaration relates are in conformity with the following standards or other normative documents following the provisions of Directives

2006/42/EC (Machinery Directive)

2014/30/EU (EMC Directive)

2011/65/EU (RoHS II)

The machine satisfies the requirements for PL=d and Category 3
in accordance with EN ISO 13849-1

EN 60204-1	(Safety of Machinery – Electrical Equipment of Machines)
EN 61000-6-1	(EMC Immunity for residential, commercial and light-industrial environments)
EN 61000-6-2	(EMC Immunity for industrial environments)
EN 61000-6-3	(EMC Emission standard for residential, commercial and light-industrial environments)
EN 61000-6-4	(EMC Emission standard for industrial environments)
EN ISO 13849-1	(Safety of Machinery – Safety-related parts of control systems)
EN16500	(Machines for compacting waste materials or recyclable fractions – Vertical baling presses – Safety requirements)

If the product is altered in any way that has not been approved by us,
this declaration of conformity shall no longer be valid

Sävsjö 22.02.2023

A handwritten signature in blue ink, appearing to read "Philip Karlsson", with a horizontal line extending to the right.

Philip Karlsson

Compiler of technical documentation

DIMENSIONS and TECHNICAL SPECIFICATIONS

Please see dimensional drawing on the following page	3325	3420	3820
A* – Installed height (mm)	A ² - 2380	A ² - 2380	A ² - 2576
B – Transport height (without blocks)	2080 (1980)	2080 (1980)	2080 (1980)
C – Height up to loading aperture (mm)	1153	1153	1144
D – Loading aperture (mm)	520	520	630
E – Width (mm)	1775	1775	2075
F – Depth (mm)	1060	1060	1060
G – Width of loading aperture (mm)	1200	1200	1500
Depth with door open (mm)	2325	2325	2625
Weight (kg)	1095	1080	1270
Recommended floor space for a machine in operation.			
Height, (minimum) (mm)	2480	2480	2676
Width (mm)	2975	2975	3275
Depth (mm)	3475	3475	3775
Bale size (wxdxh) (mm)	1200x800x1150	1200x800x1150	1500x800x1140
Bale weight, cardboard (kg)	up to 400 kg	up to 400 kg	up to 500 kg
Bale weight, plastic (kg)	up to 450 kg	up to 450 kg	
Recommended strap (LP=Plastic; HP=Paper)	(HP) VG13; 4872248-00 (LP) 13HD; 4872305-00	VG13HD; 4872305-00	(HP)G13HD; 4872305-00 (LP)G19HD; 4872304-00
Noise level	≤ 65 db (A)	≤ 65 db (A)	≤ 65 db (A)
Paint	Two-part paint and powder coat with phosphatising as base.		
ELECTRICAL DATA	3325	3420	3820
Operating voltage	3X400V; 50 Hz	3X400 V; 50 Hz	3X400 V; 50 Hz
Electrical connection	5-polig CEE-plugg,	5-pin CEE plug,	5-pin CEE plug,
Fuse (max)	16 A	16 A	16 A
Electric motor	4.6 kW	4.6 kW	4.6 kW
Operating voltage	3x200 V; 50/60 Hz	3x200 V; 50/60 Hz	3x200 V; 50/60 Hz
Electrical connection	---	---	---
Fuse (max)	20 A	20 A	20 A
Electric motor	4.6 kW	4.6 kW	4.6 kW
Operating voltage	3x208 V; 60Hz	3x208 V; 60 Hz	3x208 V; 60 Hz
Electrical connection	---	---	---
Fuse (max)	20 A	20 A	20 A
Electric motor	4,6 kW	4.6 kW	4.6 kW
Operating voltage	3x230 V; 50 Hz	3x230 V; 50 Hz	3x230 V; 50 Hz
Electrical connection	4-polig CEE-plugg, 32 A	4-pin CEE plug, 32 A	4-pin CEE plug, 32 A
Fuse (max)	20 A	20 A	20 A
Electric motor	4,6 kW	4.6 kW	4.6 kW
Operating voltage	3x440-480 V; 60 Hz	3x440-480 V; 60 Hz	3x440-480 V; 60 Hz
Electrical connection	---	---	---
Fuse (max)	15 A	15 A	15 A
Electric motor	4.6kW	4.6 kW	4.6 kW
Control voltage	24V DC via transformer		
Rated current	Please see rating A on the data plate on the machine.		
Power consumption (max operation for one hour) (3x400 V)	2 kW	2,2 kW	2,2 kW
Standby-by consumption	29 W	29 W	29 W
Protection class	IP55	IP55	IP55
HYDRAULIC DATA			
Pump flow (litres/min)	17	17	17
Working pressure, cardboard (bar)	235	235	235
Press force, cardboard (kN)	260	260	260
Working pressure, plastic (bar)	160	160	160
Press force, plastic (kN)	180	180	180
Cycle time, total (secs)	24	24	24
Piston stroke (mm)	1000	1000	1000
Recommended oil - +5°C to +40°C	ISO VG 32-68, mineral oil		
- below 5°C	A special oil should be used at lower temperatures.		
Oil volume (litres)	23	23	23

DIMENSIONAL DRAWING

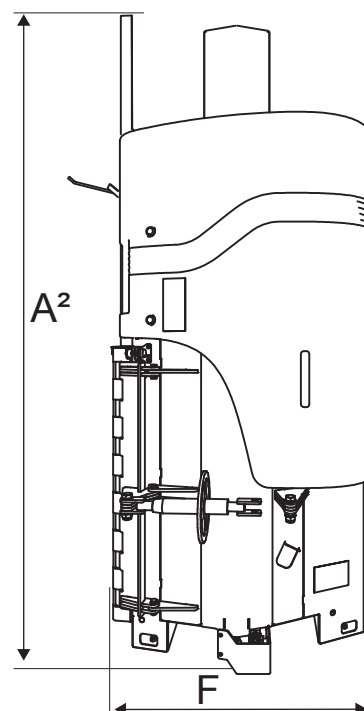
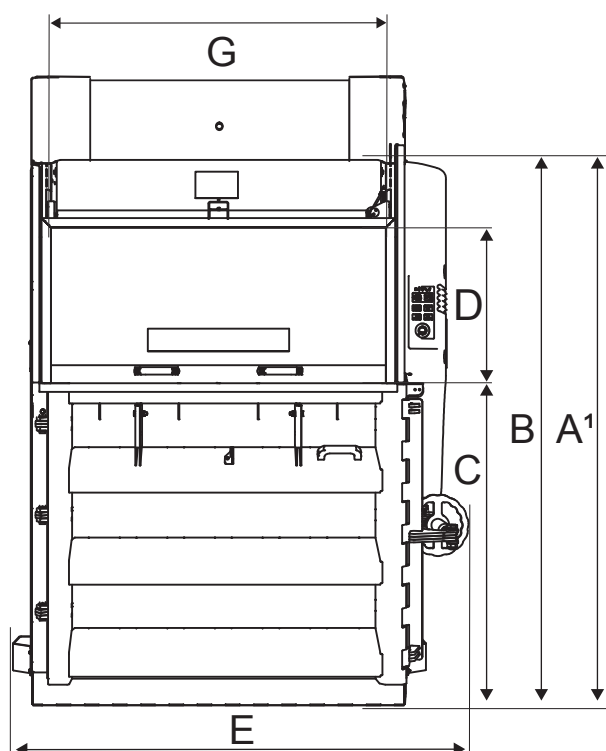

TRANSPORT

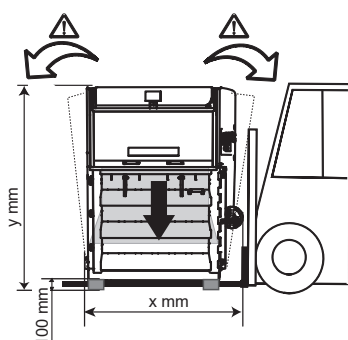
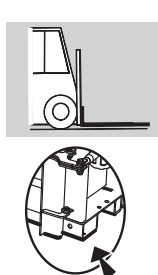

Model	x (mm)	y (mm)	(kg)
3325	1835	2080	1095
3420	1835	2080	1080
3820	2105	2080	1270



The machine has a high centre of gravity. Before moving the machine, the press plate should be fully lowered and the sliding door should be locked mechanically in its lowered/closed position.

Manual machine (MAN): Close the sliding door. Press the 'Down arrow'. Lock the sliding door mechanically.
Automatic machine (AUTO): Change to manual mode (MAN). Close the sliding door. Press the 'Down arrow'. Lock the sliding door mechanically.



If the machine was supplied with blocks (enabling it to be lifted backwards/forwards) these must be removed during installation (see the section INSTALLATION). It is only permissible to lift the machine from the front or rear side with the help of a forklift truck/counterweight truck.

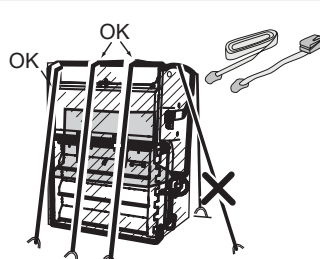
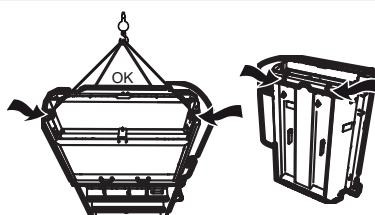
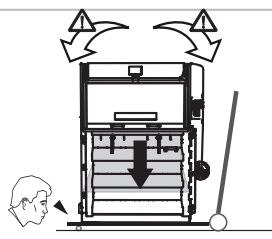
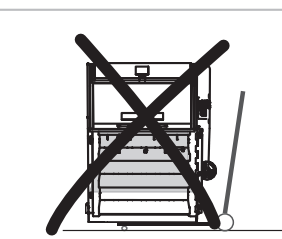
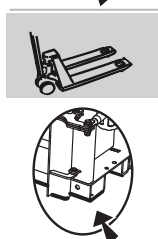
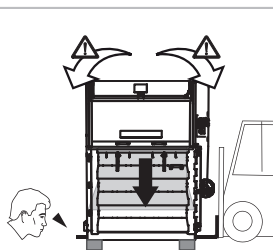
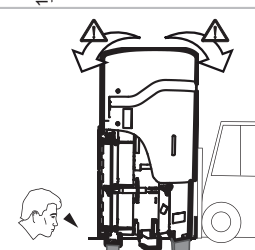
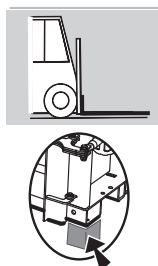

INSTALLATION TEXT FOR THE ILLUSTRATIONS ON THE FOLLOWING PAGE



Please read the whole instructions before commencing the installation!

Failure to follow the instructions may result in personal injury.

The installation must be carried out by trained personnel.

Some of the operations involve dangerous machine movement. Take every precaution, as there is a great risk of serious crushing injuries.



The machine comes preset to MAN (manual) from the factory, and should remain so throughout the entire installation process.

Make sure that no one other than the installer is present in the vicinity of the machine during the installation.

Only one person must carry out the installation.



Electrical installation should be carried out by a qualified electrician. The electrician should perform an electrical test on the socket (high-voltage test and insulation test) before the machine is installed and connected.

The ceiling height, the swing radius of the door and sufficient space for servicing, etc. must be taken into account.



A warning is also given of the risk of crushing between the upper part of the press plate/the sliding door on the machine (applies to models 3325/3420/3820) and whatever is situated above it, e.g. the ceiling. Risk of crushing!

The installation height of the machine is higher than its transport height (see dimensions under TECHNICAL SPECIFICATIONS).



1. Transport the machine to the intended installation site. Lift the machine from the **hydraulic power unit side** (see also the section *TRANSPORT*).

Note the installation dimensions - the operator must have enough space to be able to stand on the right side of the machine during baling.

2. Remove the plastic packaging, the wooden protection around the machine, its attachments and any transport braces on the top of the machine. Leave the transport boards under the machine in place.



3. Remove the mechanical locking that secures the sliding door.

NOTE! - the sliding door will now rise (applies to models 3420/3820).

4. Open the door and take out the strap, strap holder, bale tool and rubber tiles. Close the door.

5. Then unscrew and remove all 4 of the nuts for the transport blocks (spanner size 19).

6. Carefully lift the machine sufficiently high to allow all the transport blocks to be removed.

7. Carefully lower the machine onto the rubber tiles (3325 and 3420), or the machine feet (3820). Make sure that the machine is level. Remove the transport boards (under the machine) and their attachments.

8. Place the strap holders in the strap holder brackets and hang up the strap hook on the side of the machine.

9. Check the oil level when the press plate is in its lowest position. The oil level can be seen through the slot on the plastic cover.



10. Make sure that there is sufficient ceiling space.

11. Connect the machine to the mains.

12. 3325: Dangerous machine movement. Check the direction of rotation of the motor by depressing the arrow up button for about five seconds. If the press plate has not moved upwards, press the emergency stop immediately, remove the plug, rotate the phases and try again.

13. 3420/3820: **Dangerous machine movement!** Hold down the sliding door manually, and check the direction of rotation of the motor by simultaneously depressing the up-arrow button for about five seconds. If the press plate does not move upwards or if the service light begins to flash, press the emergency stop button immediately, remove the plug, rotate the phases and try again.

14. Fit the covers over the ends of the press plate. These are essential for safety.

Operate the machine for one press cycle to verify that the cover guards are correctly fitted.

Once the machine is installed, the installation engineer and owner must make sure that nobody can be injured due to the risk of being crushed on top of the machine between the moving parts found there and whatever is above them, e.g. the ceiling. The installation process is now complete, and the machine can be set to automatic mode (AUTO) if so desired.

RECYCLING AND DISPOSAL

In the event of the machine being scrapped, the applicable environmental legislation relating to disposal and recycling should be complied with. The machine is mainly constructed of sheet steel. It also contains electrical and hydraulic components as well as hydraulic oil (the volume of hydraulic oil, in litres, is indicated in the section Technical specifications). The cover over the electrics and hydraulics is made of ABS plastic. The circuit board includes a removable battery. Contact your nearest recycling facility for guidance on handling waste products.

INSTALLATION

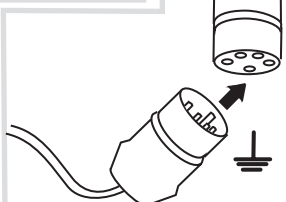
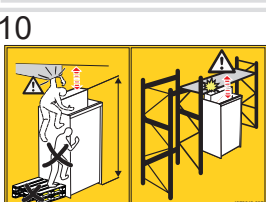
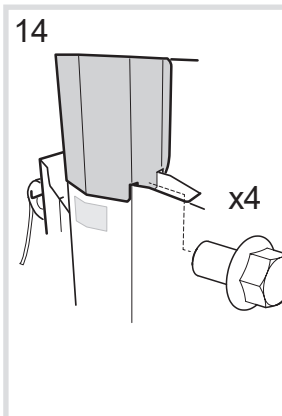
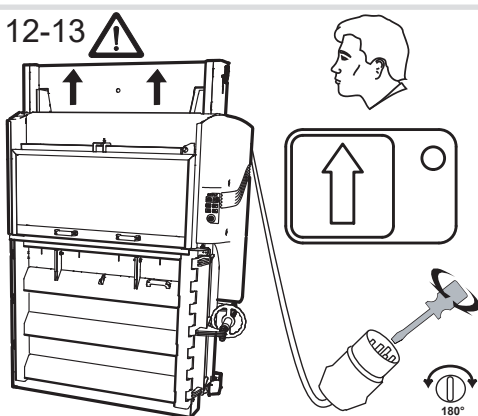
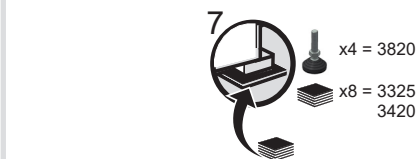
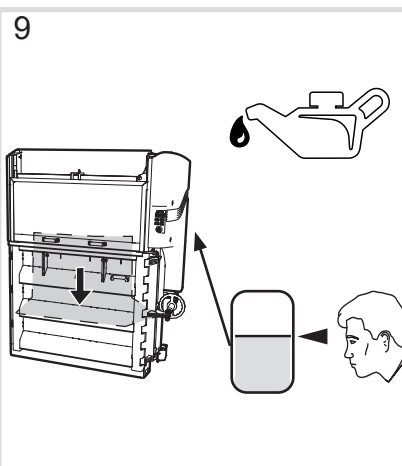
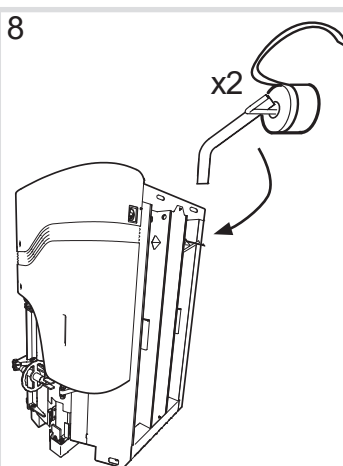
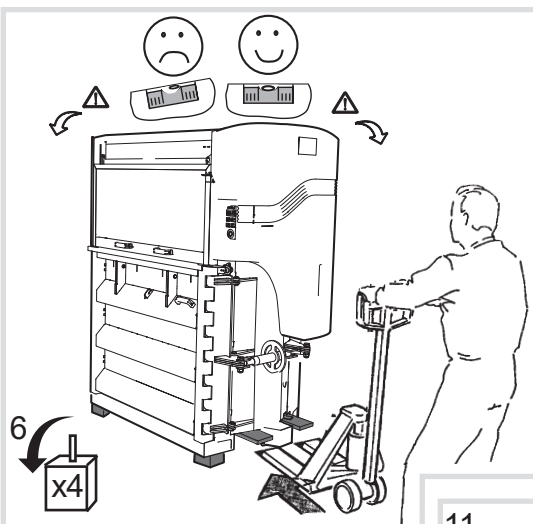
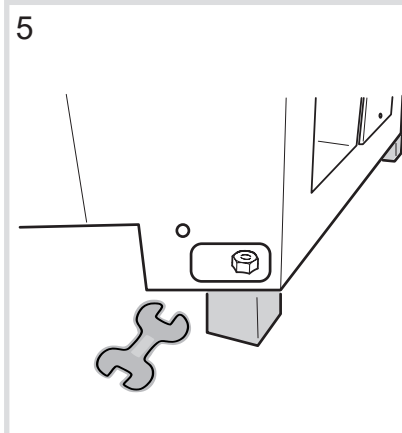
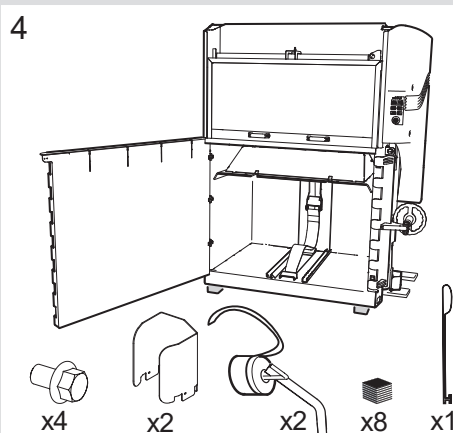
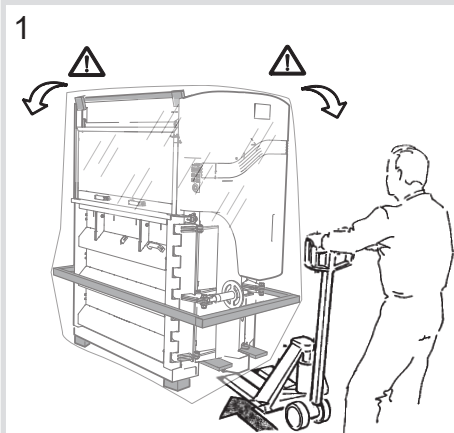
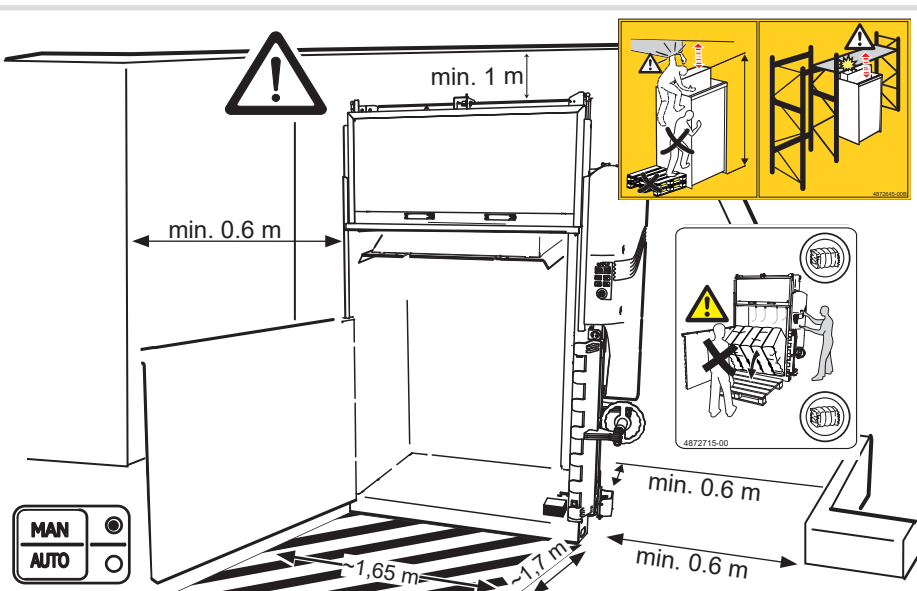
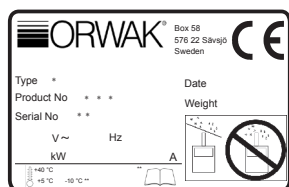
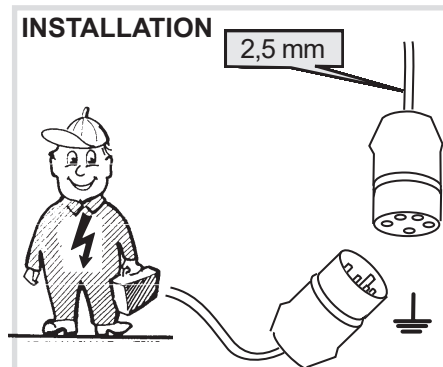

ELECTRICAL WIRING DIAGRAM

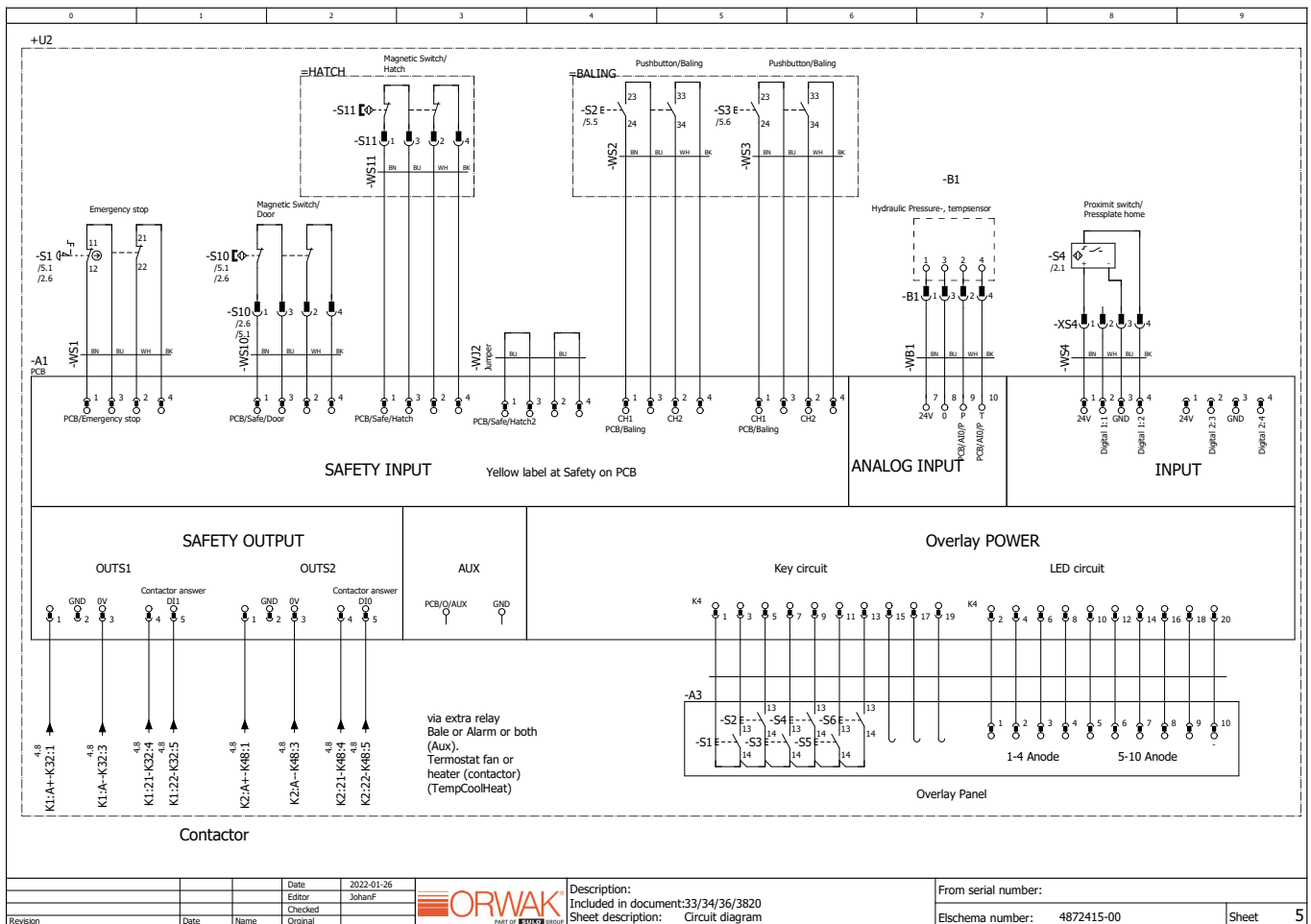
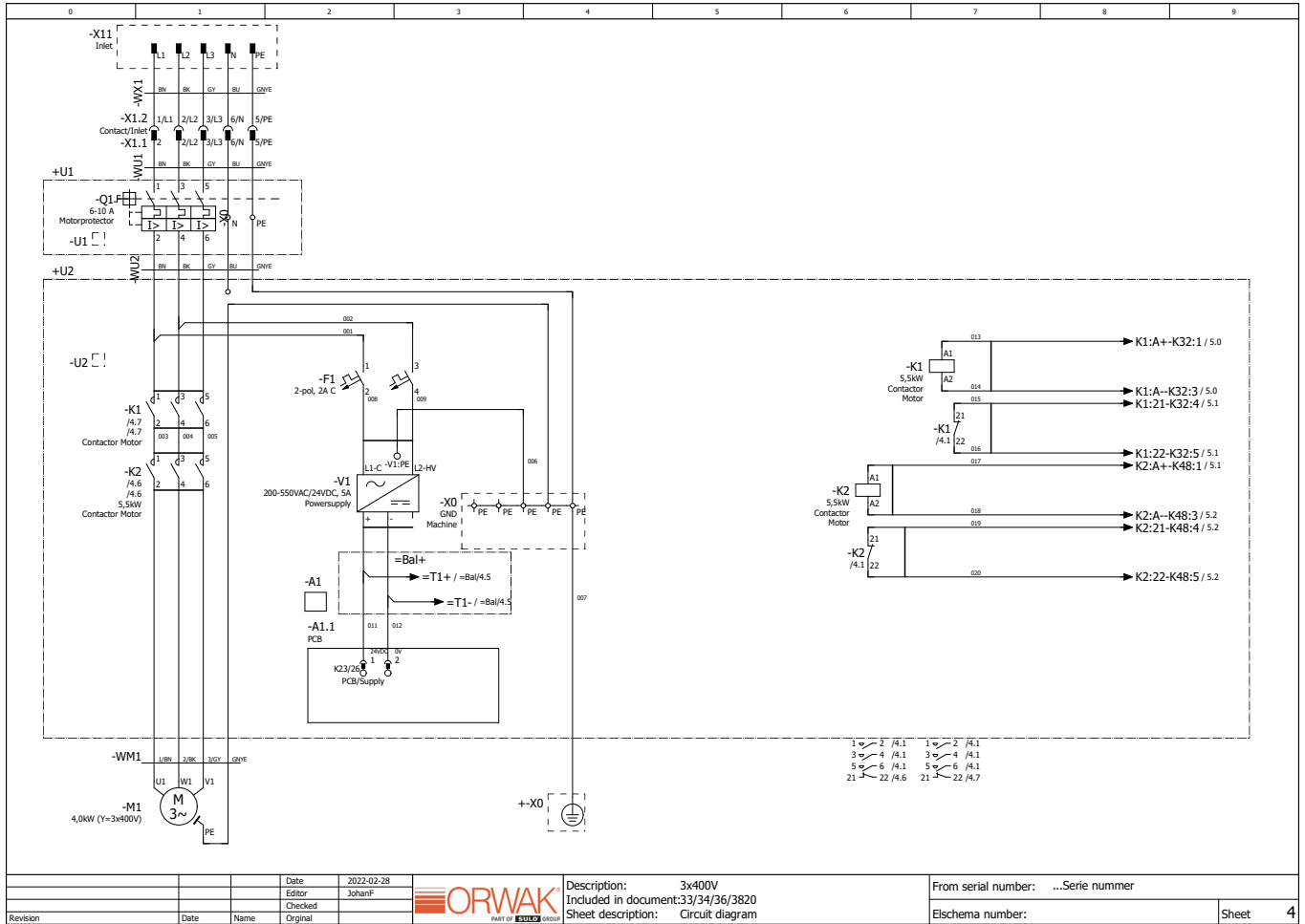

ELECTRICAL WIRING DIAGRAM

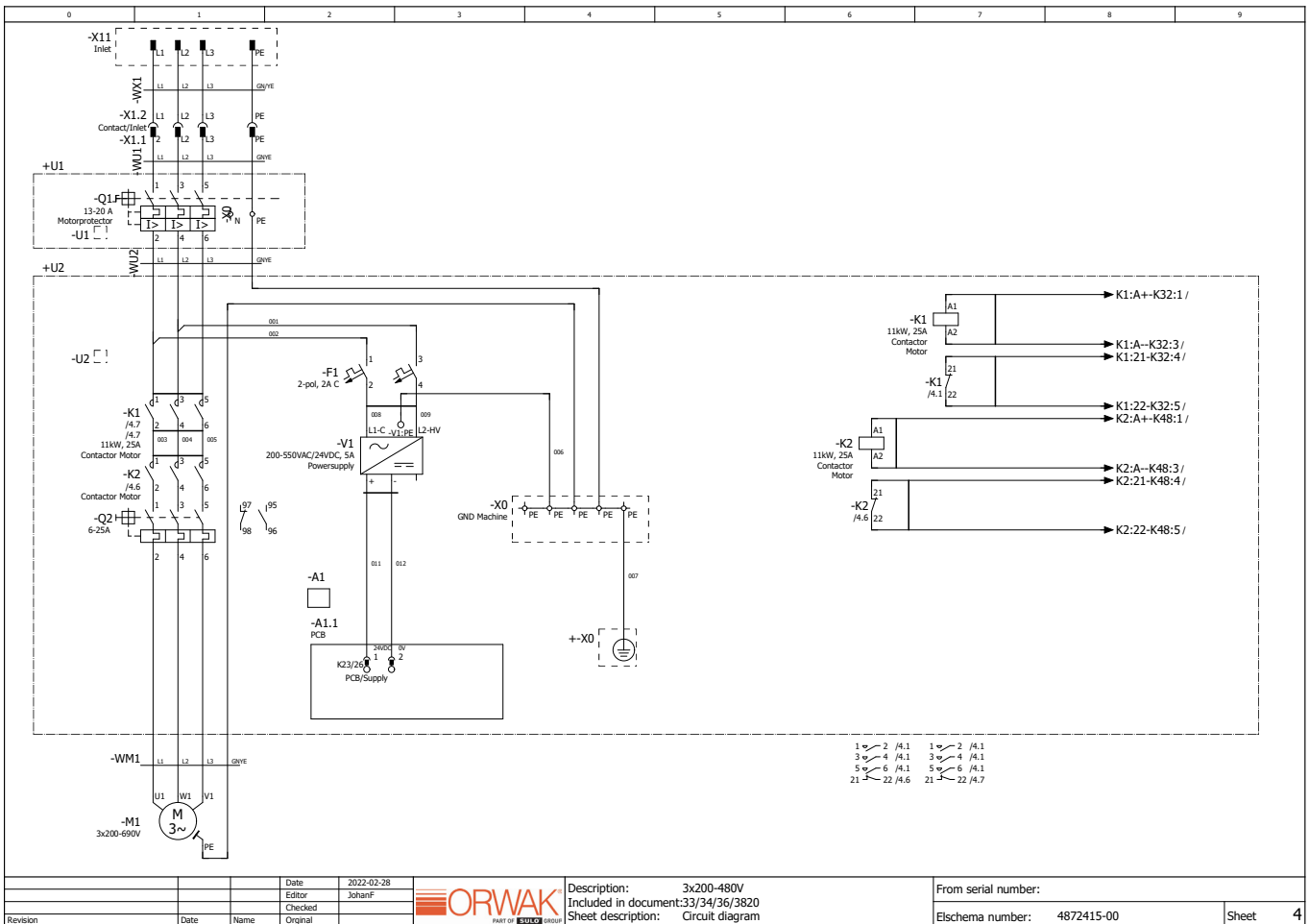
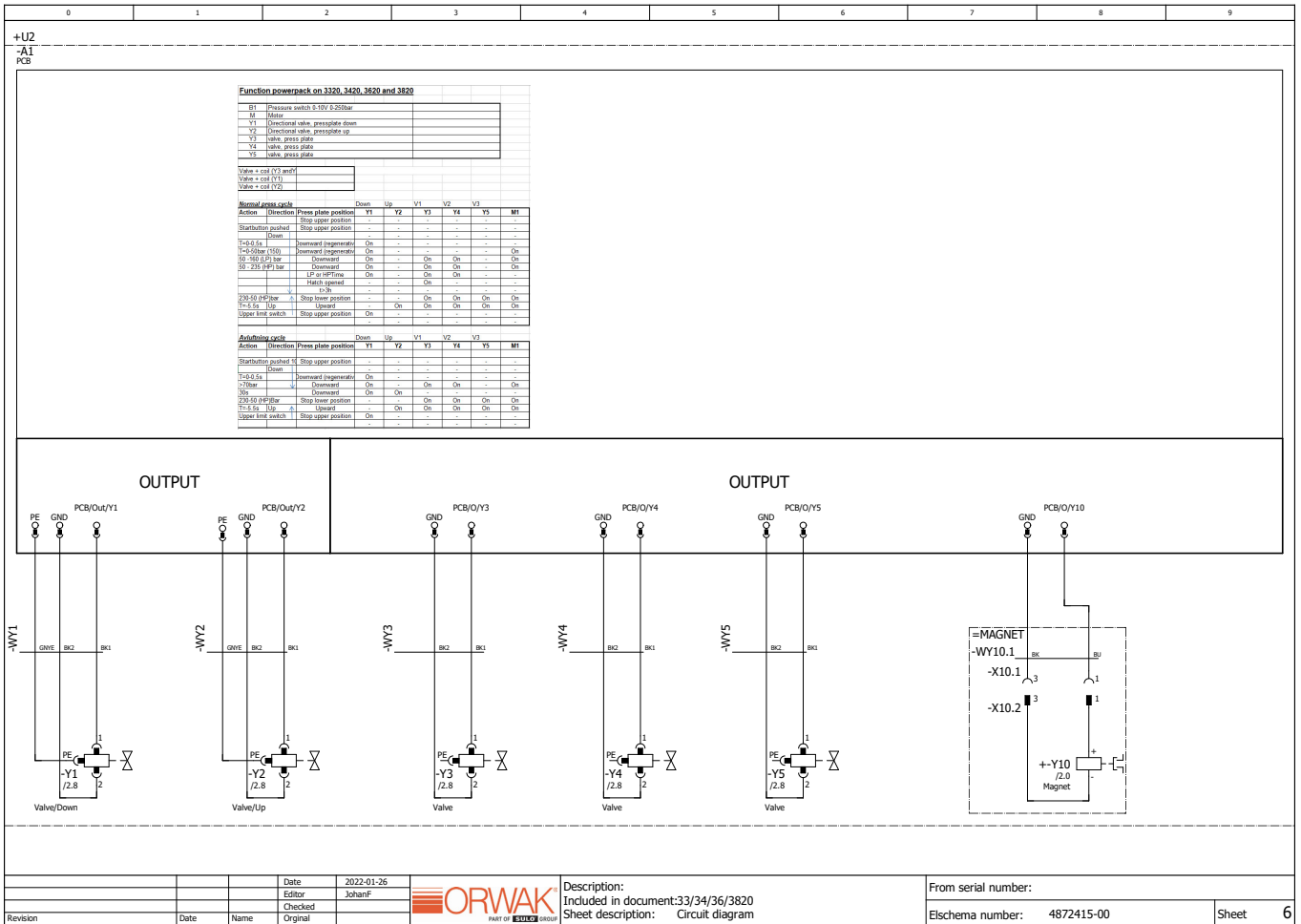

HYDRAULIC DIAGRAM

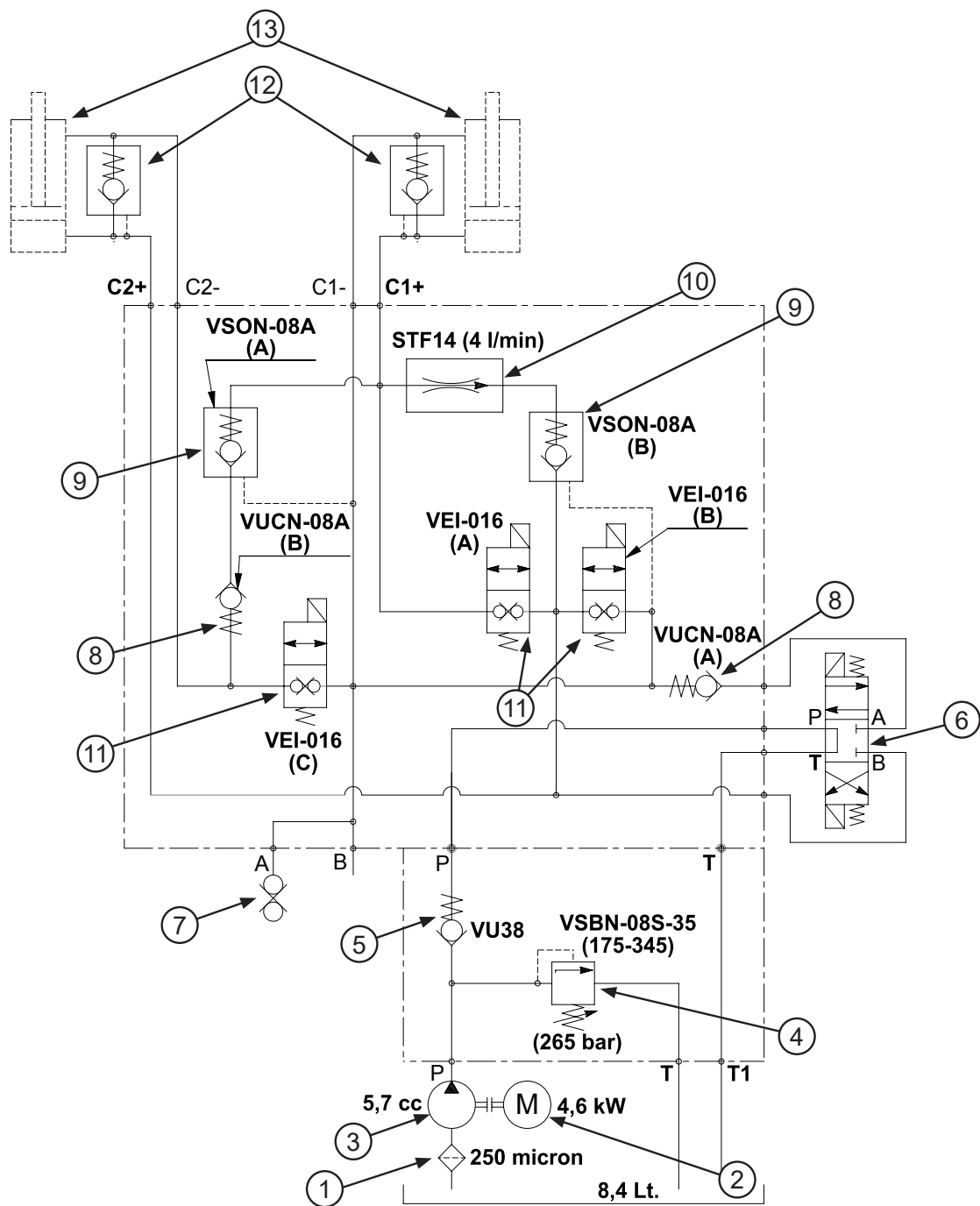

Item no.	Description				
	Svenska	English	Deutsch	Français	Español
1	Filter	Filter	Filter	Filtre	Filtro
2	Elmotor	Electrical motor	Elektrische Motor	Moteur	Motor
3	Pump	Pump	Pumpe	Pompe	Bomba
4	Avlastningsventil	Relief valve	Umgehungsventil	Soupape de décharge	Válvula de derrame
5	Backventil	Check valve	Rückschlagsventil	Soupape de retenue	Válvula de retención
6	Riktningsventil	Directional valve	Richtungsventil	Guide de soupape	Válvula
7	Tryckgivare	Pressure sensor	Druck-Sensor	Sonde de pression	Sensor de la presión
8	Backventil	Check valve	Rückschlagsventil	Soupape de retenue	Válvula de retención
9	Backventil	Check valve	Rückschlagsventil	Soupape de retenue	Válvula de retención
10	Flödesventil	Flow control valve	Ventil	Soupape	Válvula
11	Ventil	Valve	Ventil	Soupape	Válvula
12	Cylinderblock	Cylinder block	Zylinderblock	Bloc	Bloco
13	Hydraulicylinder	Hydraulic cylinder	Hydraulikzylinder	Vérin hydraulique	Cilindro hidráulico

COMPACTION SOLUTIONS FOR MOST TYPES OF WASTE

ORWAK develops solutions for sorting and recycling waste materials that improve business efficiency, contribute to a cleaner working and natural environment to provide the best total waste handling economy.

We offer an innovative range of products that promotes sorting at source and make waste management more profitable.

ORWAK AB
Svetsaregatan 4
S-57622 Sävsjö
SWEDEN
Tel: +46-(0)382-15700
info@orwak.com

ORWAK.COM

 **ORWAK**[®]
PART OF **SULO** GROUP